

# ASHCROFT®

## Fire Protection Sprinkler Service Gauge

- *For wet and dry systems*
- *Patented Spring Suspended Movement*
- *Underwriters Laboratory Listed*
- *Factory Mutual approved*



**ISO 9001**  
REGISTERED FIRM



**DRESSER** INSTRUMENT

Ashcroft Fire Protection Sprinkler pressure gauges are Underwriters Laboratory Listed and Factory Mutual approved for fire protection sprinkler service.

The 0/300 psi pressure range of this gauge is used on "wet" systems where water is available to the sprinkler heads.

The 0/80 retard to 250 psi pressure ranges are used on dry systems where the lines are filled with air pressure until system activation.

Among the features of these pressure gauges are:

- The patented Spring Suspended Movement with polyester segment designed to provide unequalled shock and vibration resistance resulting in superior performance.
- Ultrasonically cleaned and silicone lubricated gearing to assure smooth operation and extended gauge life.
- Corrosion resistant ABS (Acrylonitrile Butadiene Styrene) case meets Underwriters Laboratory UL-393, and Factory Mutual requirements.

**Product Specifications**

- Ashcroft Model Number: 1005P, XUL
- Size:** 3½" Diameter
- Case:** ABS (Acrylonitrile Butadiene Styrene Blend)
- Window:** Polycarbonate
- Dial:** Black figures on white background
- Pointer:** Black, Aluminum
- Movement:** Patented Spring Suspended with Polyester Segment
- Bourdon Tube:** Bronze
- Socket:** Brass, Soft Soldered
- Connection:** ¼ NPT Lower
- Accuracy:** ASME B40.1, Grade B (±3-2-3%)
- Mounting:** Stem
- Ranges:** 0/300 psi (water)  
0/80 retard to 250 psi (air)

U.L., U.L. of Canada Listed and FM approved.

Equivalent (single or dual scale) metric ranges are available. Other U.L. standard ranges available on application.

**Dimensions**

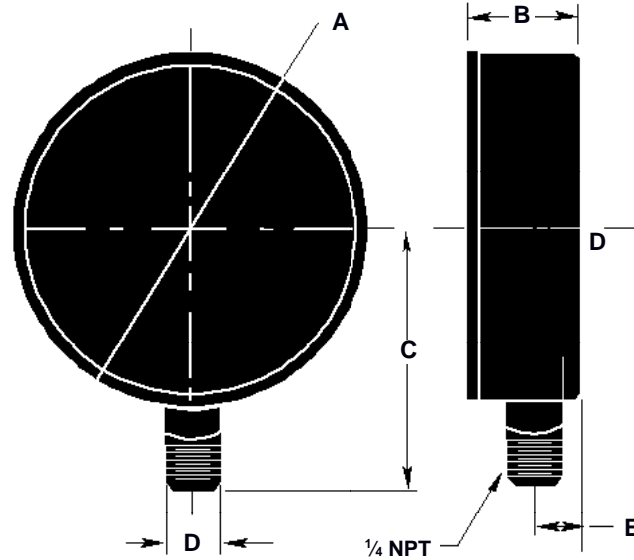

SIZE/TYPE	A	B	C	D	E
3½"	0.70	1.14	0.72	0.56	0.47
1005P	(94)	(29)	(69)	(14.2)	(11.9)

**Order Information**

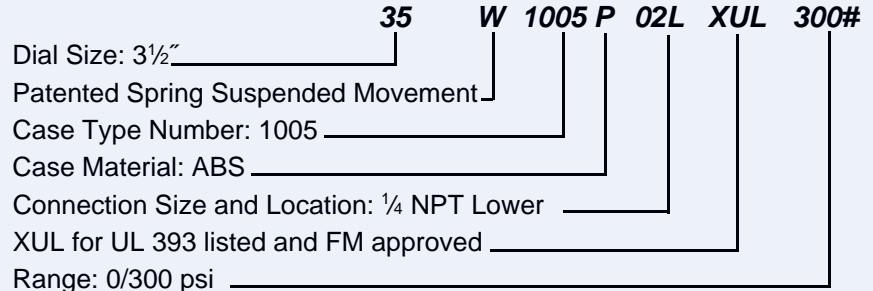

**Domestic Headquarters**

**Berea, Kentucky**  
200 Harrison Road  
Berea, KY 40403  
Tel: (859) 986-9333  
Fax: 1-800-28 BERE A  
(1-800-282-3732)

**International Headquarters**

**Stratford, Connecticut**  
250 E. Main Street  
Stratford, CT 06614-5145  
Tel: (203) 378-8281  
Fax: (203) 385-0499

**Sales Offices**

**Chicago, Illinois**  
400 W. Lake Street  
Suite 318  
Roselle, IL 60172-3573  
Tel: (630) 980-9030  
Fax: (630) 980-9440

**Los Angeles, California**  
3931 MacArthur Blvd.  
Suite 202  
Newport Beach, CA 92660  
Tel: (714) 852-8948  
Fax: (714) 852-8971

**Stratford, Connecticut**  
250 E. Main Street  
Stratford, CT 06614-5145  
Tel: (203) 385-0670  
Fax: (203) 385-0756

**Mobile, Alabama**  
605 Bel Air Blvd., Suite 10  
Mobile, AL 36606  
Tel: (334) 473-1692  
Fax: (334) 473-1782

**Houston, Texas**  
3838 North Sam Houston  
Parkway East, Suite 120  
Houston, TX 77032  
Tel: (281) 590-1092  
Fax: (281) 590-7100