

AVAILABLE  
FROM STOCK

# ASHCROFT<sup>®</sup>

## Commercial Gauges Type 1000, 2071A



The tradition of providing accurate, distinctive, reliable pressure instruments continues in Ashcroft 4½" Type 1000 and type 2071A commercial gauges.

Ashcroft 4½" Type 1000 gauges utilize a black steel case and ring, with a glass window. These gauges are appropriate for general industrial applications and can be customized to complement your equipment.

Ashcroft 4½" Type 2071A, Contractor gauges, are constructed with a back flanged aluminum case, painted black, and a chrome ring with glass window. These gauges are designed to meet the needs of heating, ventilating, plumbing and air conditioning contractors. The accuracy of these gauges is ASME B40.1, Grade A,  $\pm 2-1-2\%$ .

Incorporated in both, Type 1000 gauges and Type 2071A gauges, is the PowerFlex™ movement. This movement provides superior resistance to shock, vibration, and pulsation; thereby assuring longer life for your pressure instrument.

True Zero™ indication, a standard feature on these gauges, reduces the potential risk of installing a damaged gauge on your equipment. Other benefits of this unique safety feature include reduced manufacturing and inspection costs.

As in all Ashcroft commercial instruments, the dial artwork is designed to provide gauges that are consistent in appearance, attractive, and easy to read.



Visit our website @ [www.dresser.com/instruments/](http://www.dresser.com/instruments/)



INSTRUMENT  
DIVISION **DRESSER**  
BEREA OPERATIONS  
BULLETIN CG - 10/21

**Product Specifications**

**Ashcroft Model Number:** 1000, 2071A

- Size:** 4½"
- Case:** 1000 - Black painted steel  
2071A- Black painted aluminum with back flange
- Ring:** 1000 - Black painted steel, friction fit  
2071A- Chrome plated steel, friction fit
- Window:** Glass
- Dial:** Black figures on white background, steel
- Pointer:** 1000 - Black, Aluminum  
2071A- Adjustable, Black, Aluminum
- Bourdon Tube:** 1000 - Bronze  
2071A- Bronze, soldered, siphon required for steam service
- Movement:** PowerFlex with polyester segment
- Socket:** Brass
- Connection:** 1/4" NPT lower
- Ranges:** Vacuum - 600 psi and compound
- Accuracy:** 1000 - ASME B40.1, Grade B, ± 3-2-3%  
2071A- ASME B40.1, Grade A, ± 2-1-2%

**Optional Features**

- Case:** Case color (other than black)
- Window:** Plastic
- Pointer:** Adjustable (Type 1000)
- Socket:** Nickel Plated  
Throttle plugs – 0.007", 0.013", 0.020", 0.063" orifices
- Others:** Customized dials  
Chrome ring (Type 1000)  
Black ring (Type 2071A)  
Non-standard ranges  
Special calibration on application

**Dimensions**

**T-1000**

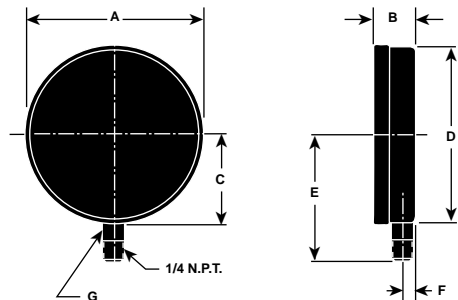

**T-2071A**

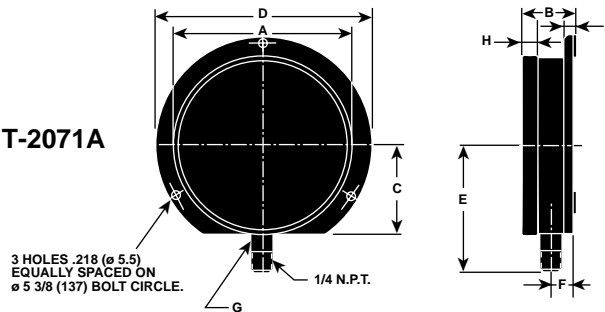

T-1000 4½"	A	B	C	D	E	F	Wrench Flats G	Weight
Inches	4.75	1.13	2.34	4.69	3.38	0.34	9/16	12 oz.
mm	(121)	(29)	(60)	(119)	(86)	(9)	(14)	

T-2071A 4½"	A	B	C	D	E	F	Wrench Flats G	H	I	Weight
Inches	4.75	1.41	2.38	5.81	3.38	0.47	9/16	0.42	0.25	16 oz.
mm	(121)	(36)	(60)	(148)	(86)	(12)	(14)	(11)	(6)	

**How to Order** 45 W 1000 H 02L X(AP) 100#

Dial Size: 4½" \_\_\_\_\_

PowerFlex Movement \_\_\_\_\_

Case type number: 1000 \_\_\_\_\_

Socket material: Brass \_\_\_\_\_

Connection size/location: 1/4" Lower \_\_\_\_\_

Option: Adjustable Pointer \_\_\_\_\_

Range: 100 psi \_\_\_\_\_

**Domestic Headquarters**

**Berea, Kentucky**  
Harrison Road  
Berea, KY 40403  
Tel: (606) 986-9333  
FAX 1-800-28 BEREAS  
(1-800-282-3732)  
email:dresser-berea-mkt@dspn.com

**International Headquarters**

**Stratford, Connecticut**  
250 E. Main Street  
Stratford, CT 06497  
Tel: (203) 378-8281  
FAX: (203) 385-0499

**Sales Offices**

**Chicago, Illinois**  
400 W. Lake Street,  
Suite 318  
Roselle, IL 60172-3392  
Tel: (630) 980-9030  
FAX: (630) 980-9440

**Houston, Texas**  
3838 N. Sam Houston  
Parkway East, Suite 120  
Houston, TX 77032  
Tel: (281) 590-1092  
FAX: (281) 590-7100

**Hartford, Connecticut**  
1501 East Main St.  
Meriden, CT 06450-2860  
Tel: (203) 235-0450  
Fax: (203) 235-0593

**Los Angeles, California**  
3931 Mac Arthur Blvd.,  
Suite 202  
Newport Beach, CA 92660  
Tel: (714) 852-8948  
FAX: (714) 852-8971

**Mobile, Alabama**  
851 South Bellline Hwy., Suite 402, Mobile, AL 36606  
Tel: (334) 473-1692 Fax: (334) 473-1782

Specifications subject to change without notice.  
Subject to standard terms and conditions of sale.  
Copyright Instrument Division, Dresser Industries Inc., 5/95

