

Introducing the Ashcroft® Type 1259 Process Gauge

Features include. . .

- Solid Front Safety Case
- 0.5% Accuracy complies with ASME B40.1
- As-Welded Bourdon Tube for Safety and Longer Life
- Adjustable Movement
- Ranges: vac. to 20,000 psi

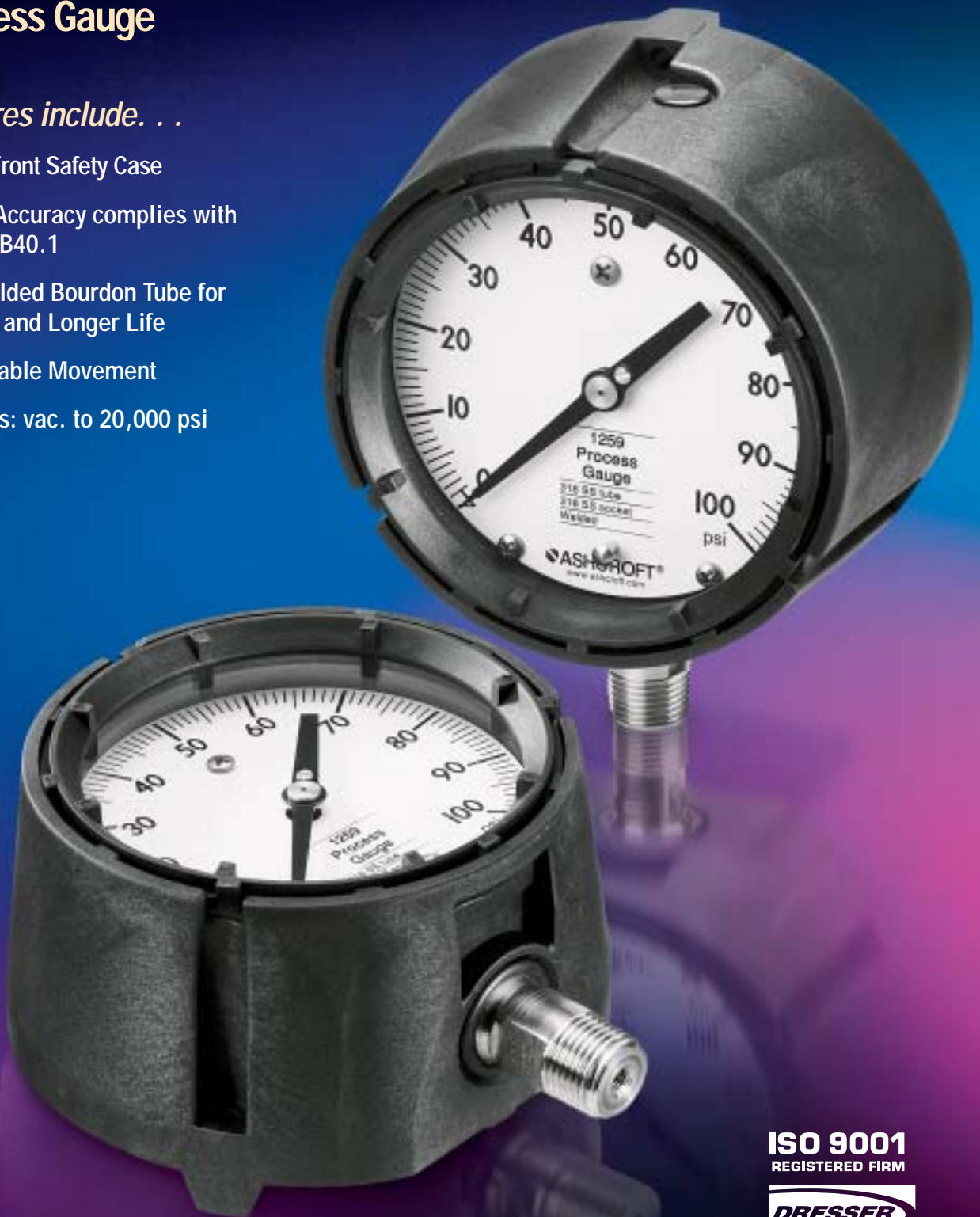

ISO 9001
REGISTERED FIRM

DRESSER

Instruments

BULLETIN PR-1

SPECIFICATIONS

Accuracy (ASME B40.1, Grade 2A):
 ½% full scale
Case Style: Solid front with full blow-out back, dry, liquid filled or hermetically sealed
Case Material: Fiberglass reinforced thermoplastic
Dial Size: 4½"
Dial Stop Pin: 6:00 o'clock
Ring Type: Cam lock, fiberglass reinforced thermoplastic
Bourdon Tube/Socket Material: 316L SS/steel (R), 316L SS (S)
Range Limits (psi): Vacuum-20,000
Connection Size: ¼ NPT, ½ NPT Others on application
Connection Location: Lower only
Mounting: Stem, flush, surface
Movement: 300 series stainless steel
Window: Glass (standard). Acrylic and safety glass (optional)
Pointer: Micrometer adjustable
Liquid Fills: Glycerin (standard), Silicone and Halocarbon (optional)

OPTIONAL FEATURES

CASE & RING OPTIONS	CODE	COMMENTS
Flush Mounting Ring – Steel, Black Epoxy	56	
Flush Mounting Ring – SS, Polished	57	
Hermetically Sealed, Weatherproof Case	H	
BOURDON TUBE & SYSTEM ASSEMBLY OPTIONS		
Overload Stop	OS	Protects the gauge against pressure beyond the maximum range.
Throttle Screw – Stainless Steel	TS	Standard with liquid filled or hermetically sealed gauges 0.020" standard. Other sizes: .0135, .031, .040, .050, and .070.
Cleaning For Gaseous Oxygen	6B	If gauge is liquid filled, specify Halocarbon as the fill.
LIQUID FILLING OPTIONS		
Silicone Fill	GV	500 cts viscosity
Halocarbon Fill	GX	For oxidizing media. (Examples: chlorine, oxygen, nitric acid and sulfuric acid.)
WINDOW OPTIONS		
Acrylic Window	PD	Ambient temperature limits –50/180°F.
Shatterproof Glass	SG	Ambient temperature limits –50/200°F.
MARKING & TAGGING OPTIONS		
Dial Marking	DA	Service marking printed on dial.
Stainless Steel Tagging of Gauge	NH	300 series stainless steel tag wired to gauge.
TEST & CERTIFICATE OPTIONS		
Certificate of Conformance	CD-1	Conformance to specifications and/or drawings.
Individual Certified Calibration Chart	CD-4	C4 (code)

RANGE TABLES

PSI RANGES		METRIC RANGES					
Pressure – psi	Range ⁽¹⁾	Pressure – kg/cm ² and bar (Outer Scale)		Pressure – kPa (Outer Scale)		Pressure – mPa (Outer Scale)	
0/15	0/1	0/1.6	0/22	0/100	0/14	0/0.1	0/14
0/30	0/1.6	0/2.5	0/35	0/160	0/22	0/0.16	0/22
0/60	0/2.5	0/4	0/55	0/250	0/35	0/0.25	0/35
0/100	0/4	0/6	0/85	0/400	0/55	0/0.4	0/55
0/160	0/6	0/10	0/140	0/600	0/85	0/0.6	0/85
0/200	0/10	0/16	0/220	0/1000	0/140	0/1	0/140
0/300	0/16	0/25	0/350	0/1600	0/220	0/1.6	0/220
0/400	0/25	0/40	0/550	0/2500	0/350	0/2.5	0/350
0/600	0/40	0/60	0/850	0/4000	0/550	0/4	0/550
0/800	0/60	0/100	1400	0/6000	0/850	0/6	0/850
0/1000	0/100	0/1600	2200	0/10,000	1400	Vacuum	Outer Scale
0/1500	0/160	0/2500	3500	0/16,000	2200	–0.1/0	30"Hg
0/2000	0/250	0/4000	5500	0/25,000	3500	Compound	
0/3000	0/400	0/6000	8500	0/40,000	5500	–0.1/0/0.15	30"Hg/20
0/4000	0/600	0/10,000	14,000	0/60,000	8500	–0.1/0/0.3	30"Hg/40
0/6000	0/1000	0/16,000	22,000	0/100,000	4,000	–0.1/0/0.5	30"Hg/70
0/10,000	0/1600	Vacuum	Outer Scale	0/160,000	22,000	–0.1/0/0.9	30"Hg/125
0/20,000	–1/0	–100/0	30"Hg	Vacuum	Outer Scale	–0.1/0/1.5	30"Hg/215
Vacuum		–100/0	30"Hg	–100/0	30"Hg	–0.1/0/2.4	30"Hg/340
30/0 in.Hg		Compound		Compound			
34/0 ftH ₂ O		–1/0/1.5	30"Hg/20	–100/0/150	30"Hg/20		
Compound		–1/0/3	30"Hg/40	–100/0/300	30"Hg/40		
30"Hg/15 psi		–1/0/5	30"Hg/70	–100/0/500	30"Hg/70		
30"Hg/30 psi		–1/0/9	30"Hg/125	–100/0/900	30"Hg/125		
30"Hg/60 psi		–1/0/15	30"Hg/215	–100/0/1500	30"Hg/215		
30"Hg/100 psi		–1/0/24	30"Hg/340	–100/0/2400	30"Hg/340		
30"Hg/150 psi							
30"Hg/300 psi							

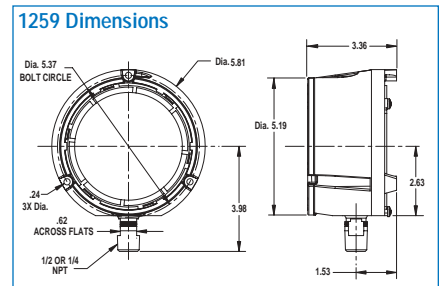

250 E. Main Street
 Stratford, CT 06614
 Tel: (203) 378-8281
 Fax: (203) 385-0499
www.ashcroft.com

Specifications subject to change without notice.
 Subject to standard terms and conditions of sale.
 ©Copyright 2004 Dresser Instruments, Dresser, Inc.
 All rights reserved. W/O4P 11/04

HOW TO ORDER –

Example, Single Scale: 45 1259SD 04L XSG 100#

SIZE		CASE TYPE		CASE STYLE & MATERIAL		CONNECTION SIZE & TYPE		CONNECTION LOCATION		OPTIONS		RANGES	
Code	Desc.	Code	Desc.	Code	Desc.	Code	Desc.	Code	Desc.	Code	Desc.	Code	Desc.
45	4½"	1259	Solid Front	SD	316L SS Tube/Socket – Dry Gauge	02	¼ NPT	L	Lower	XSG	Safety Glass	100#	0/100 psi
				SL	316L SS Tube/Socket – Liquid Filled Gauge†	04	½ NPT				See Optional Feature Chart for Entire List of Options		See Chart for List of Standard Ranges